

DATE June 20, 1952

ATLANTA URBAN LEAGUE NEIGHBORHOOD INFORMATION DATA SHEET

1. Name of Neighborhood Bush Mountain (OAKLAND CITY)
2. Origin of Name _____
3. Location, boundaries, direction and distance from the heart of the city of Atlanta (Map of area, p. 5) Atlanta, Ga; Almont Ave, Bridges Ave Bush Mountain Ave, Oakland Drive; Southwest of Atlanta; Four miles from heart of city.

4. County Fulton Incorporated: Yes _____ No
5. Population: Negro Approx. 150 Families White _____ Total 4,992
6. Number of Registered Voters: Negro _____ White _____
7. Number of Citizens over 18 years of age: Negro _____ White _____

8. Name, address, denomination, and estimated membership of churches serving the Negro population:

Name	Address	Denom.	Mem	Pastor's Name
<u>West Oakland Baptist</u>	<u>Oakland Ave.</u>	<u>Baptist</u>	<u>125</u>	<u>No Pastor</u>
<u>Ladd St. Church</u>	<u>Ladd St.</u>	<u>A.M.E.</u>		<u>H. Fisher</u>
_____	_____	_____	_____	_____
_____	_____	_____	_____	_____
_____	_____	_____	_____	_____
_____	_____	_____	_____	_____
_____	_____	_____	_____	_____
_____	_____	_____	_____	_____
_____	_____	_____	_____	_____

9. Schools: Elementary (Negro)

Name	Grades	Enr'd	Number of Teachers	Number of Classrooms	Condition of Plant
<u>Bush Mountain School</u>	<u>1st thru 7th</u>	<u>92</u>	<u>2</u>	<u>2</u>	<u>Very Poor</u>
_____	_____	_____	_____	_____	_____

10. Elementary (White)

_____	_____	_____	_____	_____	_____
_____	_____	_____	_____	_____	_____
_____	_____	_____	_____	_____	_____

11. High Schools (Negro)

Name	Grades	Enrol.	No. of Teachers	No. of Class rms.	Condition of Plant
No High School in Community. Appx. 20 students attend Turner High School. They travel through town pack outside town to school.					

12. High Schools (White)

Brown High					

13. Names and purposes of projects sponsored by organized community groups:

- (a) P.T.A.
- (b) Use To have a Civic Club
- (c) _____

14. Names and function of social work agencies at work in the community:

- (a) None
- (b) _____
- (c) _____

15. Name and kind of social and recreational facilities:

- Negro Mr. Orr's Recreation Park (business)
- White School auditorium and gymnasium

16. Name and kind of health facilities:

- Negro Use to have health Clinic. Some people use Ben Hill Health Clinic.
- White _____

17. Sources of community income:

Negro	White
<u>Women - Domestic Work</u>	<u>Bus Drivers</u>
<u>Use to have a Rock Quarry</u>	<u>Business</u>
<u>Men do skilled + Unskilled Work</u>	

18. Community needs according to local resources:

19. What are the provisions for the following public services:

- (a) Streets None
- (b) Sewage and Water Running Water + Sewage
- (c) Garbage Collection _____
- (d) Police Protection _____
- (e) Fire Protection Fire Hydrants
- (f) Mail Service No House delivery
- (g) Transportation Facilities East Point + Hapeville Buses
- (h) Others _____

20. List the names and kinds of neighborhood businesses operated in the Negro community. (Indicate those owned by Negroes)

- (a) Mr. Orr's Recreation Business
- (b) _____
- (c) _____
- (d) _____
- (e) _____
- (f) _____

21. What is the general condition of the neighborhood in terms of housing, appearance, etc.?

Houses are in poor general condition and appearance.
Some houses are not facing the streets.

21. Are there many Negro home owners in the community? Yes What % Appx. 85%
No _____

22. List names, addresses and telephone numbers of suggested community leaders:

Mr. C. J. Jackson, 1017 Dower St., S.W., AM-1993, Bush MT.

Mrs. Mamie Wynne, 1245 Bush Mt. Ave, AM-8457, Bush MT.

Mrs. Ingram, 1321 Bridges Ave, Bush MT.

23. List names, addresses, professions, telephone numbers of professional persons living in the neighborhood.

24. What is your general observation regarding race relationship in the neighborhood?

Relations between Races appears to be good.

Remarks:

None of the Teachers at the school live in This area Nor do they work with groups in The community, To any extent, for Community betterment. There is a controversy among City officials concerning removing Negroes from This area, irregardless of the fact That Negroes were living the area first, and for a period of over 30yrs.

Mail is delivered to white homes throughout The area, which surrounds the Negro section where no Mail is delivered to homes at all. School mail comes direct to The school.

No school Buses for High School students (colored) even Though They have to Travel all The way into Town and back out to The edge of Town to Turner High.

DATE January 24, 1955

ATLANTA URBAN LEAGUE NEIGHBORHOOD INFORMATION DATA SHEET

1. Name of Neighborhood Bush Mountain
2. Origin of Name was once hilly area covered with trees and thick bushes
3. Location, boundaries, direction and distance from the heart of the city of Atlanta (Map of area, p. 5) 3 miles southeast of Five Points

4. County Fulton Incorporated: Yes No
5. Population: Negro approx. 250 B.Mt. White 200 O.City - Total 450
6. Number of Registered Voters: Negro 10% White -
7. Number of Citizens over 18 years of age: Negro White

8. Name, address, denomination, and estimated membership of churches serving the Negro population:

Name	Address	Denom.	Mem	Pastor's Name
<u>West Oakland</u>	<u>1225 Violet Ave.</u>	<u>Baptist</u>	<u>140</u>	<u>Rev.Wm.Calhoun</u>
<u>Ladd Street</u>	<u>Ladd Street</u>	<u>Methodist</u>	<u>100</u>	<u>J.W. Queen(Rev.)</u>
<u>Whitefield</u>	<u>Dimmock</u>	<u>Baptist</u>	<u>130</u>	<u>Rev.P.J.Ivory</u>

9. Schools: Elementary (Negro)

Name	Grades	Enrl	Number of Teachers	Number of Classrooms	Condition of Plant
<u>Bush Mountain</u>	<u>7</u>	<u>116</u>	<u>4</u>	<u>2</u>	<u>Poor</u>

10. Elementary (White)

<u>Avon Avenue</u>					

11. High Schools (Negro)

Name	Grades	Enrol.	No. of Tecsrs.	No. of Class rms.	Condition of Plant
n o n e					

12. High Schools (White)

Joe E. Brown					

13. Names and purposes of projects sponsored by organized community groups:
The Bush Mountain Progressive Civic League

- (a) Beautify homes project
- (b) Getting petitions signed for water and sewage
- (c) work in conjunction with the P.T.A.

14. Names and function of social work agencies at work in the community:

- (a) Atlanta Urban League (community chest drive and civic
- (b) education)
- (c)

15. Name and kind of social and recreational facilities:

Negro Orr Recreation Park

White Oakland Park

16. Name and kind of health facilities:

Negro none (most people go to Grady Hospital for medical treatment)

White

17. Sources of community income:

Negro	White
<u>Domestic and Personal Service,</u> <u>and laborers</u>	<u>White collar workers, clerks,</u> <u>and laborers</u>
_____	_____
_____	_____

18. Community needs according to local resources:

Improvement of school, recreation facilities, better mail
service, paved streets, and street lights *Street Signs -*

19. What are the provisions for the following public services:

- (a) Streets unpaved streets
- (b) Sewage and Water water and sewage (sewage does not go up to school)
- (c) Garbage Collection once a week
- (d) Police Protection city police protection
- (e) Fire Protection nearest fire station on Lee Street
- (f) Mail Service mail deposited in boxes on corner Bridges & Oakland
- (g) Transportation Facilities Ben Hill and Mt. Olive run up Oakland Dr
- (h) Others _____

20. List the names and kinds of neighborhood businesses operated in the Negro community. (Indicate those owned by Negroes)

- (a) Orr Grocery Store (Negro)
- (b) B & H Store (white)
- (c) _____
- (d) _____
- (e) _____
- (f) _____

21. What is the general condition of the neighborhood in terms of housing, appearance, etc.?

Bush Mountain is a very depressive-looking community with un-
paved streets, and the homes are in poor condition. Water and
sewage has recently been provided, but sewage does not run up to
the school. There seems to be little vacant land for expansion.
There has been five new homes built recently.

21. Are there many Negro home owners in the community? Yes x What % 85
No _____

22. List names, addresses and telephone numbers of suggested community leaders:

Mr. G. Howard Murdell, 1293 Bridges Ave., S.W., Ra. 1304

Rev. W. M. Calhoun, 1401 Bridges Ave., S.W., Am. 5173

Mrs. Mamie Christine Wynn, 1245 Bush Mountain Ave., Am. 8457

Mr. Orr, 971 Oakland Dr., S. W., Fr. 1044

Mrs. Mary Jenkins, 1313 Bridges Ave., Fr. 3005

23. List names, addresses, professions, telephone numbers of professional persons living in the neighborhood.

none

24. What is your general observation regarding race relationship in the neighborhood?

The economic level of both whites and Negroes is very low and both races are prejudice toward each other. There is no exchange of ideas, etc. regarding race relationships.

Remarks: The Bush Mountain community is interesting to see in terms of its sociological factors - the people are in a low economic level, they have a low educational background, the housing condition is poor, the school structure is in poor condition with water, but without sewage up to the school, and the community is located between two white communities.

The only recreational facilities is the Orr Recreation Park, which is totally unequipped and inadequate. Mr. Orr has recently asked all the citizens in the community to contribute \$10.00 toward the building of a recreation building.

Mrs. Ruth Harper, senior teacher at the Bush Mountain Elementary School stated that the Board of Education has promised to build another room on to the school next year and to provide indoor toilet facilities. The Board of Educ. feels that the school will be there indefinitely.

I feel that the problem of the community is over-all. All of the communities, both white and Negro, should get together. There should be integration, especially in the schools and park.

Because of the general location of both the ^{both} Bush Mountain and Oakland City communities, I feel that they should operate as a separate and distinct communities.

Bush Mountain is zoned for one family dwellings; Oakland City is zoned for one and two family dwellings and apartment dwellings.

MAP OF AREA

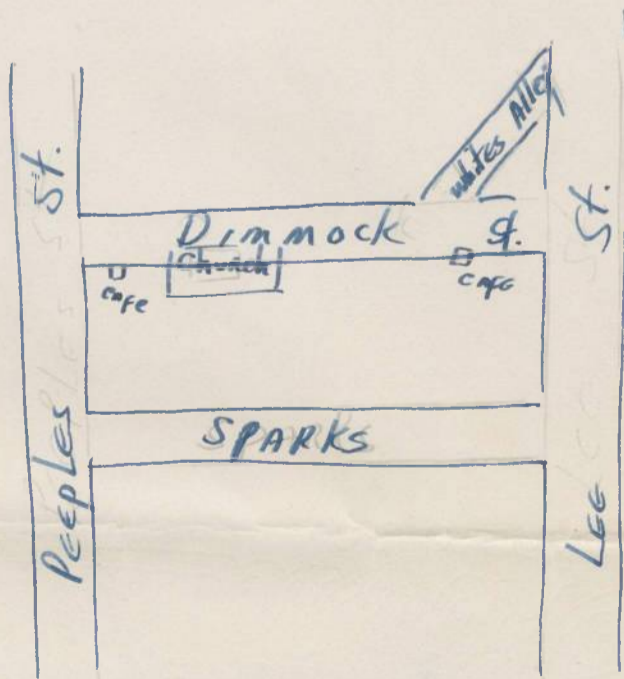
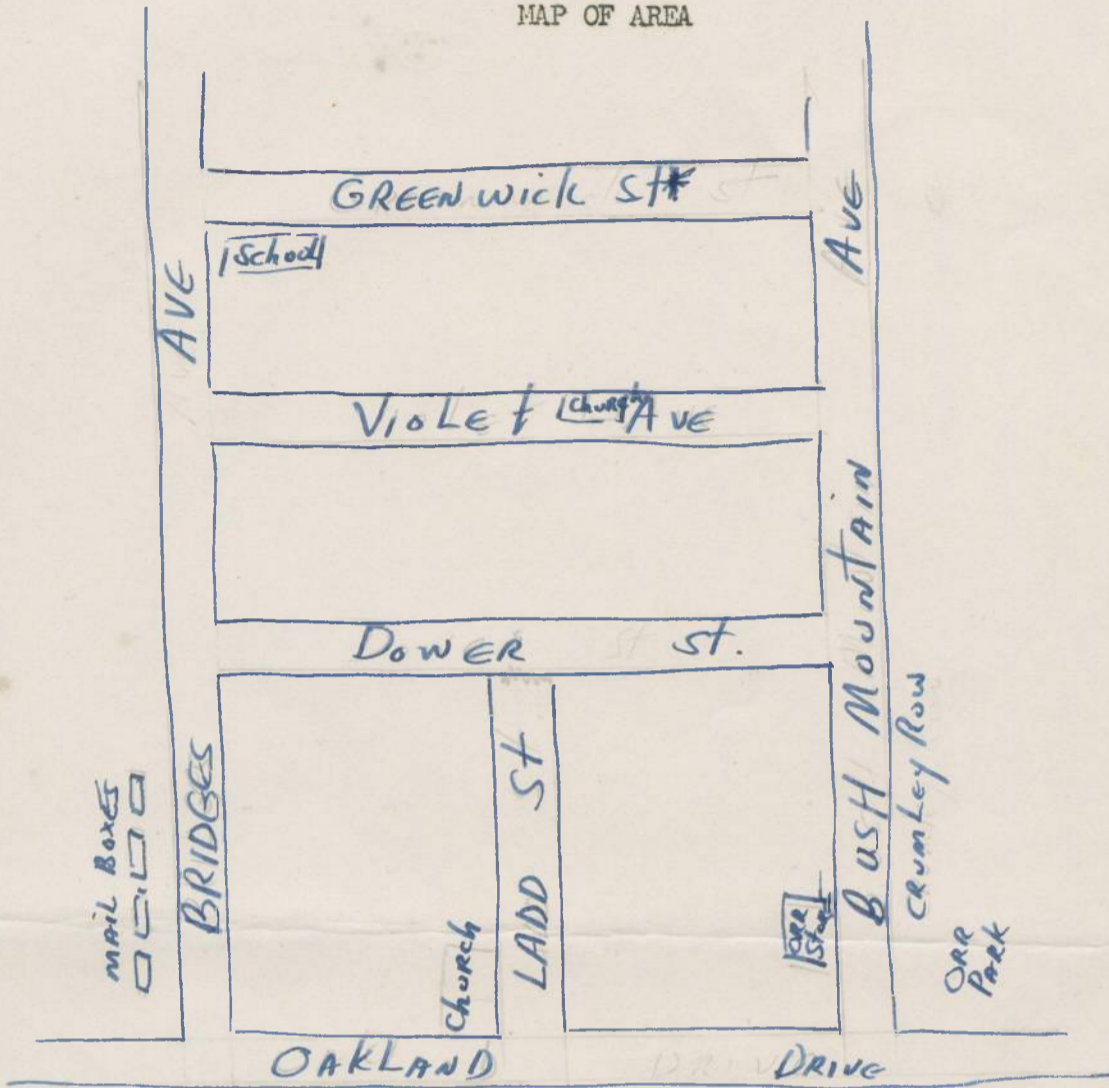

* to be cut through